

**ARIZONA STATE LAND DEPARTMENT
1110 WEST WASHINGTON STREET
PHOENIX, ARIZONA 85007**

PUBLIC AUCTION SALE NO. 53-123261

Pursuant to A.R.S. Title 37, notice is hereby given that the State of Arizona through its Arizona State Land Department (“ASLD”), will sell at Public Auction to the highest and best bidder at 11:00 a.m. on Wednesday, April 10, 2024, at the Mohave County Courthouse, 401 Spring Street, Kingman, Arizona, or another location to be announced no less than seven (7) days prior to the auction, trust lands situated in Mohave County to wit:

TOWNSHIP 21 NORTH, RANGE 21 WEST, G&SRM, MOHAVE COUNTY, ARIZONA

PARCEL: M&B THROUGH LOTS 2, 3 AND 4, S2SEW E2SW, SECTION 31,
CONTAINING 105.35 ACRES, MORE OR LESS.

LOCATION: HIGHWAY 95 AND 7TH STREET, BULLHEAD CITY, ARIZONA

BENEFICIARIES: (018) Miners Hospital for Disabled Miners, (031) Permanent Common Schools (Indemnity Selection), (049) University, and (050) University of Arizona (Act of 02/18/1881) pursuant to Fed Patent 02-87-0021

PROPERTY INFORMATION:

(A) The complete legal description of Land Sale No. 53-123261 (the “Sale Parcel”) is available in its respective file.

(B) The Sale Parcel has been appraised at \$1,650,000.00 (“Appraised Value”).

(C) There are no reimbursable improvements on the Sale Parcel.

(D) The complete file associated with the above-described Sale Parcel is open to public inspection at the ASLD, 1110 West Washington Street, Phoenix, Arizona, from 8:00 a.m. to 4:30 p.m., exclusive of holidays and weekends. Please direct any questions regarding this Public Auction to the Real Estate Division of ASLD at (602) 542-3000. This auction notice is available on the ASLD's website at <https://land.az.gov>.

BIDDING INFORMATION:

(A) Prior to the date of auction, a prospective bidder shall perform their own due diligence including, without limitation, researching the records of local jurisdictions, all ASLD files pertinent to the auction and the Sale Parcel, including, without limitation, ASLD File No. 53-123261, and files of all other public agencies regarding the Sale Parcel.

(B) On the date of auction, a prospective bidder or an authorized representative of a prospective bidder, shall attend and bid on behalf of the prospective bidder.

(C) Prior to the start of bidding, a prospective bidder shall sign an affidavit agreeing that: they have undertaken due diligence in preparation for the auction; they are purchasing the Sale Parcel solely upon the basis of their own due diligence and investigation of the Sale Parcel and not on the

basis of any representation, express or implied, written or oral, made by ASLD or its agents or employees, except as set forth in writing herein; their representative is authorized to bid and bind the bidder; and they are purchasing the Sale Parcel AS IS.

(D) Prior to the start of bidding, a prospective bidder must show ASLD's representative a **Cashier's Check** made payable to "Arizona State Land Department" in the amount specified under Terms of Sale Paragraph (F) below. If the prospective bidder is not the applicant, the amount of Cashier's Check shall be \$447,450.00. If the prospective bidder is the applicant, the amount of Cashier's Check shall be \$379,700.00.

(E) A prospective bidder who has complied with Paragraphs (A) through (D) above shall be deemed a "Registered Bidder" and may bid at the auction. ASLD shall only consider bids by Registered Bidders.

(F) The bidding will begin at the Appraised Value of \$1,650,000.00. A bid for less than the Appraised Value of the Sale Parcel will not be considered. Additional bidding must be made in minimum increments of \$100,000.00. Bidding will be conducted orally.

(G) The time of declaration of the highest and best bid shall be deemed the "Time of Sale". A Registered Bidder whose bid is declared the highest and best bid shall be deemed the "Successful Bidder". The amount of the highest and best bid shall be deemed the "Sale Price".

(H) To comply with A.R.S. § 37-240(B), ASLD shall require that the Successful Bidder must be authorized to transact business in the State of Arizona no later than ten (10) business days after the date of the auction.

(I) Pursuant to A.R.S. § 37-241(C), in the event of forfeiture by the Successful Bidder, the ASLD Commissioner may declare that the bid placed before the final bid accepted is the highest bid, and that bidder has five (5) days after notification by ASLD to pay by cashier's check all amounts due under Terms of Sale Paragraph (F) below.

(J) Persons with a disability may request a reasonable accommodation, such as a sign language interpreter by contacting the ADA Coordinator at (602) 542-2629. Requests should be made as early as possible to allow time to arrange the accommodation.

TERMS OF SALE:

(A) The Sale Parcel shall be purchased in an "AS-IS" condition "WITH ALL FAULTS", with no representation or warranty being made by ASLD of any type or nature. ASLD makes no warranty as to the following: (i) the physical condition or any other aspect of the Sale Parcel, including, but not limited to, the uses to which the Sale Parcel may be put, the ability to construct additional improvements or modify existing improvements on any portion of the Sale Parcel or the ability to obtain building permits for any portion of the Sale Parcel, the conformity of the Sale Parcel to past, current or future applicable landscaping, parking, zoning or building code requirements, the existence of soil instability, past soil repairs, soil additions or conditions of soil fill, water retention characteristics of the Sale Parcel, drainage onto or off of the Sale Parcel, the location of the Sale Parcel either wholly or partially in a flood plain or a flood hazard boundary or similar area, or any other matter affecting the stability or integrity of the Sale Parcel or any improvements constituting the Sale Parcel; or (ii) the sufficiency of the Sale Parcel for purchaser's purposes or as to its continued operating conditions or usefulness. All implied warranties, including, without limitation,

WARRANTIES OF MERCHANTABILITY OR FITNESS FOR A PARTICULAR PURPOSE, are hereby expressly disclaimed.

(B) The Sale Parcel is sold subject to existing reservations, easements, and rights of way.

(C) ASLD does not represent or warrant that access exists over lands which may intervene respectively between the Sale Parcel and the nearest public roadway.

(D) Pursuant to A.R.S. § 37-231, the State of Arizona or its predecessor in title reserve and retain all rights and all forms of access to all oil, gas, minerals, hydrocarbon substances, and gaseous substances or any other material which is essential to the production of fissionable materials as provided by the rules and regulations of ASLD and the laws of Arizona.

(E) Immediately following the Time of Sale, the Successful Bidder must sign an affidavit which states without limitation that they are the Successful Bidder and the amount of the Sale Price.

(F) Immediately following the Time of Sale, the Successful Bidder shall pay the following to ASLD by a cashier's check:

- 1) 20% of the Appraised Value of the Sale Parcel, which is \$330,000.00;
- 2) A Selling and Administrative Fee of 3% of the Appraised Value of the Sale Parcel, which is \$49,500.00;
- 3) Estimated Reimbursable Legal Advertising Costs of \$5,000.00;
- 4) Reimbursable Appraisal Fee of \$2,750.00;
- 5) Estimated Reimbursable Costs and Expenses of \$60,000.00, a portion of which amount may be refunded to the Successful Bidder if the Successful Bidder is not the applicant, and the Actual Reimbursable Costs and Expenses are lower; and
- 6) A Patent Fee of \$200.00.

The total amount due at the Time of Sale is \$447,450.00 (less \$67,750.00 if the Successful Bidder is the applicant, for a total amount due of \$379,700.00).

(G) Within thirty (30) days after the date of auction the Successful Bidder must pay:

- 1) The full balance of the Sale Price;
- 2) A Selling and Administrative Fee of 3% of the Sale Price, less the amount paid under Terms of Sale Paragraph (F)(2) above; and
- 3) The actual Legal Advertising Costs, less the amount paid under Terms of Sale Paragraph (F)(3) above.

(H) THE ENTIRE SALE PRICE, TOGETHER WITH THE AMOUNTS SPECIFIED IN (F) AND (G) ABOVE, SHALL BE DUE WITHIN 30 DAYS OF THE DATE OF AUCTION.

(I) No later than ninety (90) days after the Date of Auction or thirty (30) days after the issuance of the Patent, whichever is later, the Successful Bidder shall freely convey the fee interest in the land subject to ASLD Right-of-Way 70-115920 to the Arizona Department of Transportation.

(J) If the Successful Bidder fails to complete all payments as stated in this auction notice, the Successful Bidder shall forfeit all amounts paid, which amounts shall be deemed rent for the Sale Parcel pursuant to A.R.S. § 37-241(C)(1).

ADDITIONAL CONDITION(S):

There may be Register Eligible Site or Sites located within the subject property, which could include information significant in this state’s history, architecture, archaeology, or culture and may meet eligibility criteria, which the Arizona State Parks Board has established for listing on the Arizona Register of Historic Places, or which meet eligibility criteria for listing on the National Register of Historic Places. If ground-disturbing activities will or may impact one or more Register Eligible Site or Sites, patentee shall consult with the State Historic Preservation Office and otherwise take such actions as are necessary to avoid, preserve, protect, or mitigate impacts on the Register Eligible Site or Sites. In the event that avoidance, preservation and protection of the Register Eligible Site or Sites cannot be accomplished, patentee shall ensure a Data Recovery Plan is developed in consultation with and acceptable to, the Arizona State Museum and the State Historic Preservation Office, or their successor agencies, and the Data Recovery is implemented and completed prior to the Register Eligible Site or Sites being affected. The artifacts and records recovered from the subject property shall be curated according to the Arizona State Museum Conservation and Curation Standards as established in rules implementing the Arizona Antiquities Act.

If human remains are encountered during ground-disturbing activities, all work must immediately cease within 30.48 meters (100 feet) of the discovery and the area must be secured. The Arizona State Museum must be notified of the discovery. All discoveries will be treated in accordance with Arizona Revised Statutes (A.R.S. § 41-844 and A.R.S. § 41-865) and work must not resume in this area without authorization from the Arizona State Museum.

These conditions shall run with the subject property, and be binding on the patentee’s heirs, successors, and assigns.

BROKER INFORMATION:

In the event the Successful Bidder has retained the services of a real estate broker, the Successful Bidder shall be solely responsible for compensating that broker.

GENERAL INFORMATION:

ASLD may cancel this auction in whole or in part at any time prior to the acceptance of a final bid.

A protest to this sale must be filed within 30 days after the first day of publication of this announcement and in accordance with A.R.S. § 37-301.

THE TERMS AND CONDITIONS CONTAINED WITHIN THIS AUCTION NOTICE SHALL SURVIVE THE DELIVERY OF THE PATENT FOR THE SALE PARCEL.

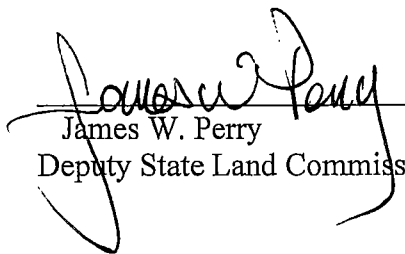
James W. Perry
Deputy State Land Commissioner



1/19/2024
Date

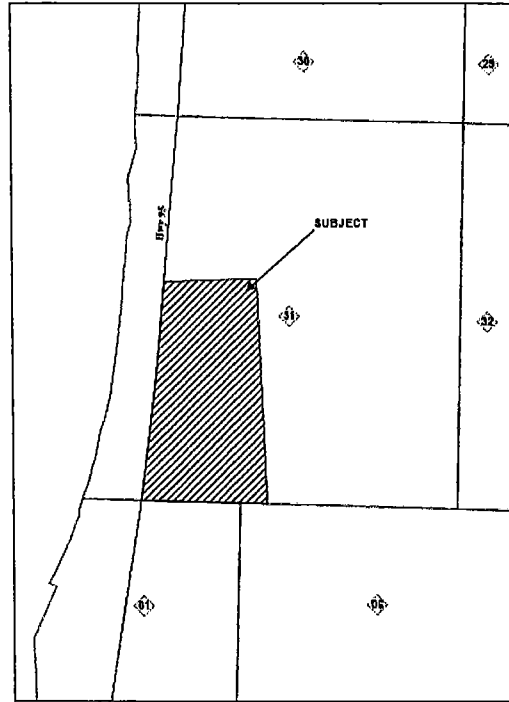

Disclaimer: This map is designed for general overview purposes only. Unless otherwise stated all depictions are approximate. Prospective bidders should review all information in ASLD's records relating to the Sale Parcel and seek technical or legal advice as needed to assure the understanding of all legal descriptions, plat maps, surveys, and other documents relevant to the Sale Parcel. Contact ASLD, Real Estate Division at (602) 542-3000 for additional information.